

Compact Muon Solenoid

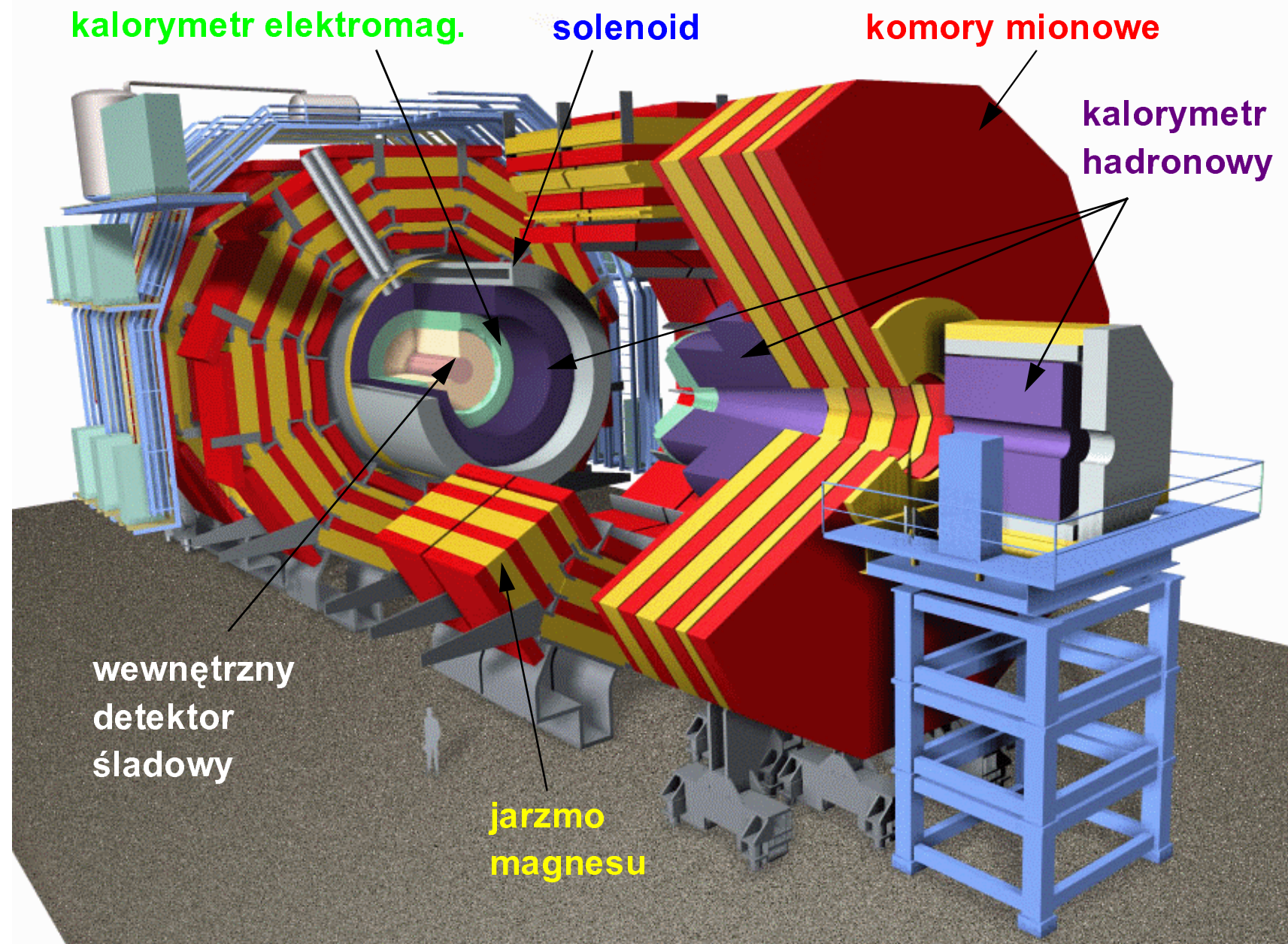

Budowa detektora CMS

SUPERCONDUCTING COIL

ECAL Scintillating $PbWO_4$ Crystals

CALORIMETERS

HCAL Plastic scintillator copper sandwich

IRON YOKE

TRACKER

Micro Strip Gas Chambers (MSGC)
Silicon Microstrips
Pixels

MUON BARREL

Drift Tube Chambers (DT)

Resistive Plate Chambers (RPC)

MUON ENDCAPS

Cathode Strip Chambers (CSC)
Resistive Plate Chambers (RPC)

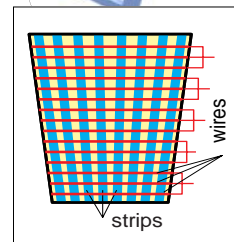
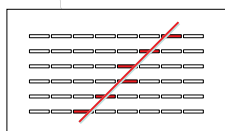
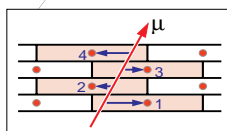
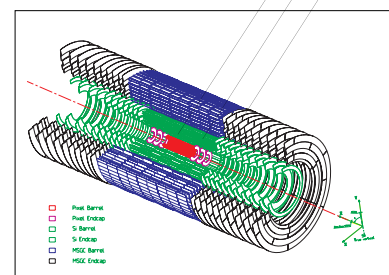

Waga 12 500 ton
Średnica 15 m
Długość 22 m
Pole magn. 4 Tesle

A Toroidal LHC ApparatuS (ATLAS)

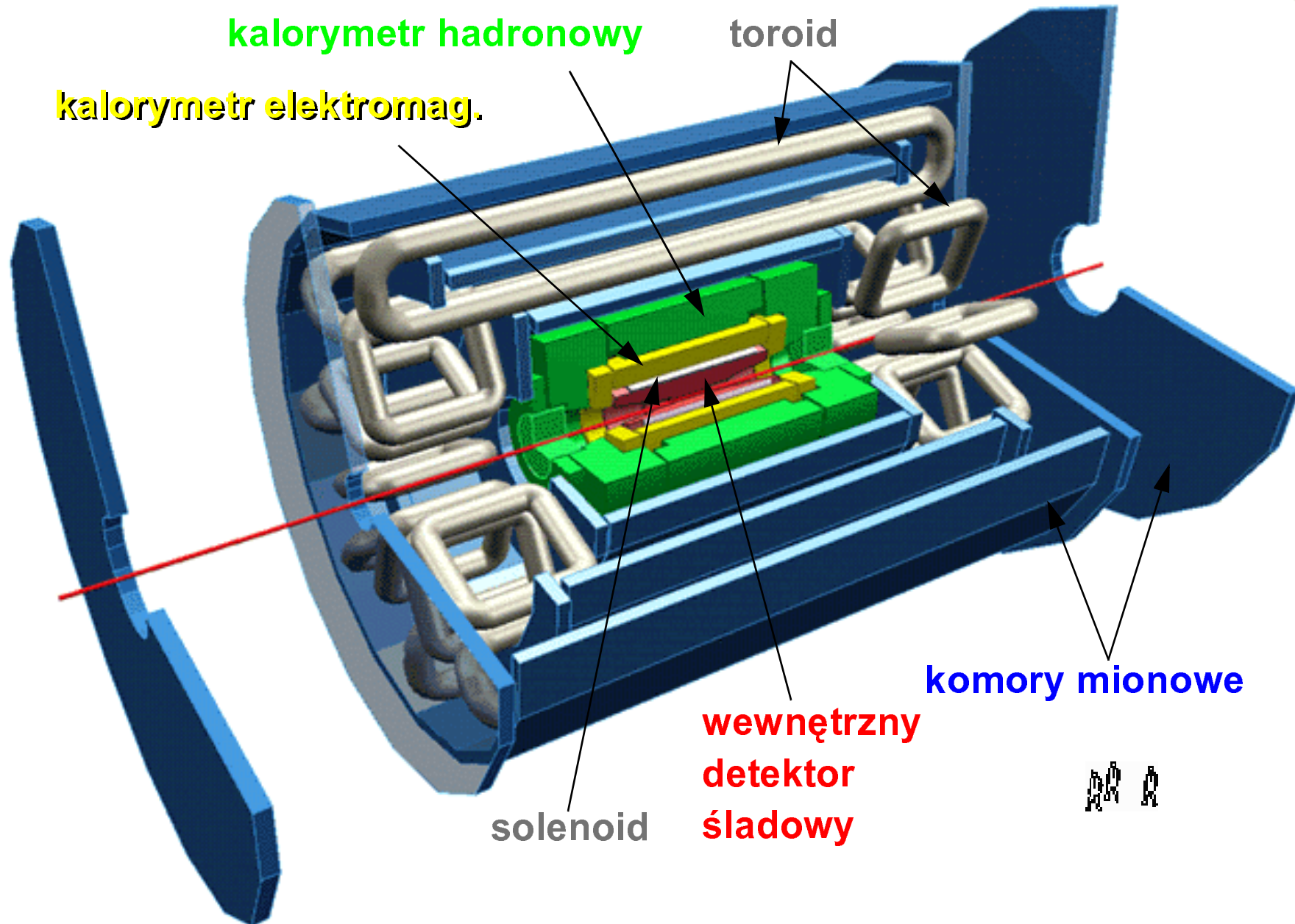

ALEPH

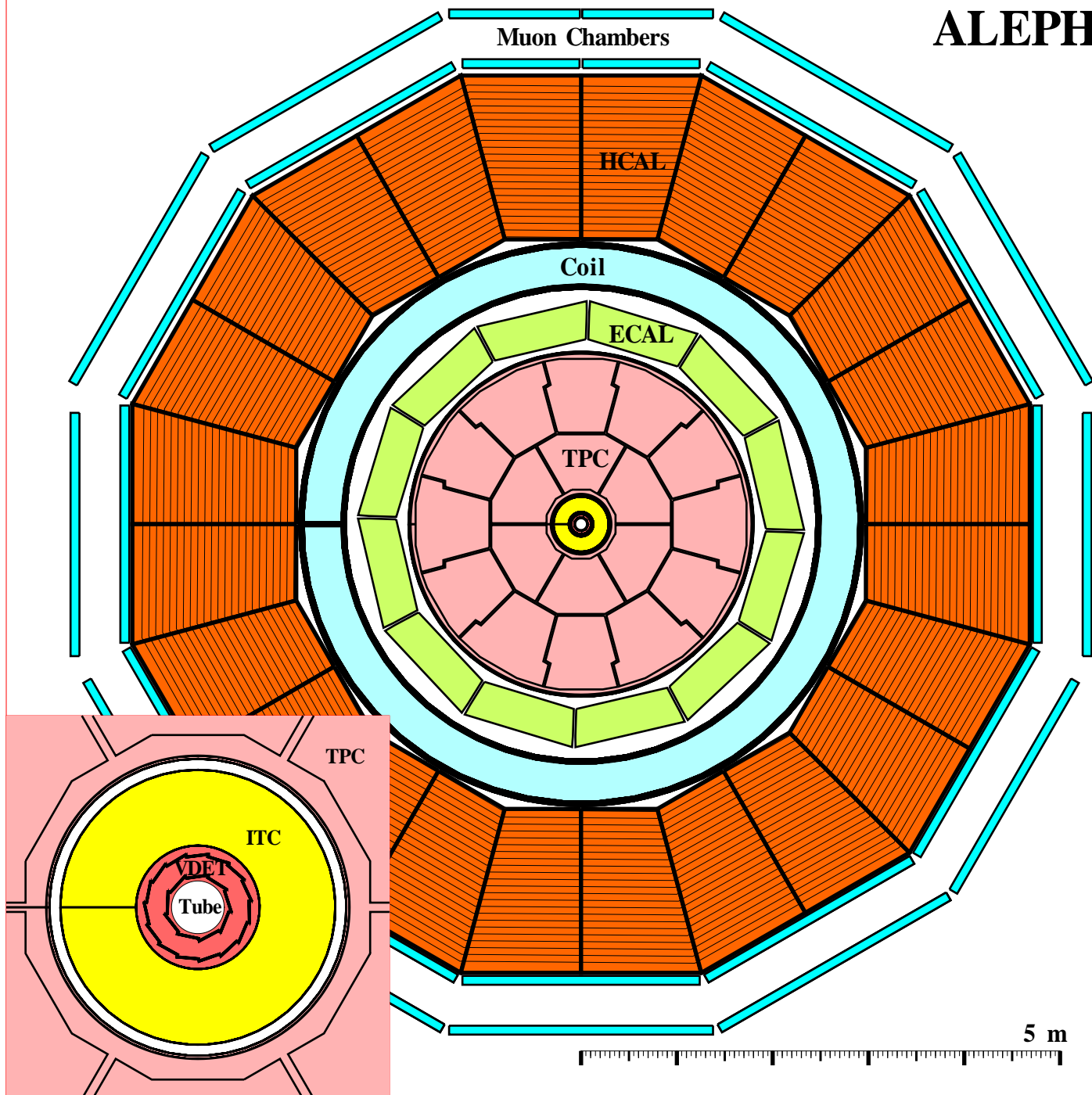

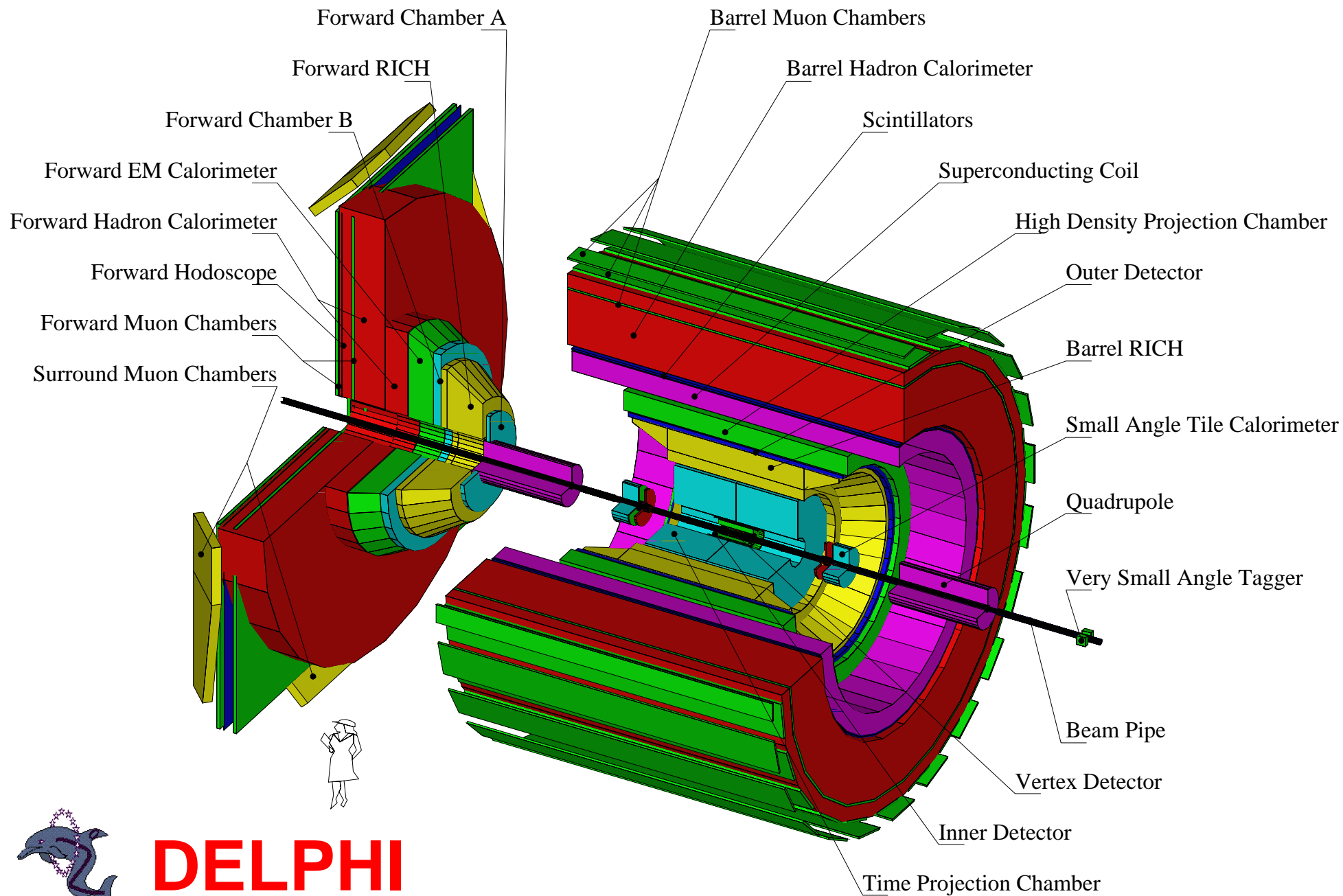

DELPHI

OPAL

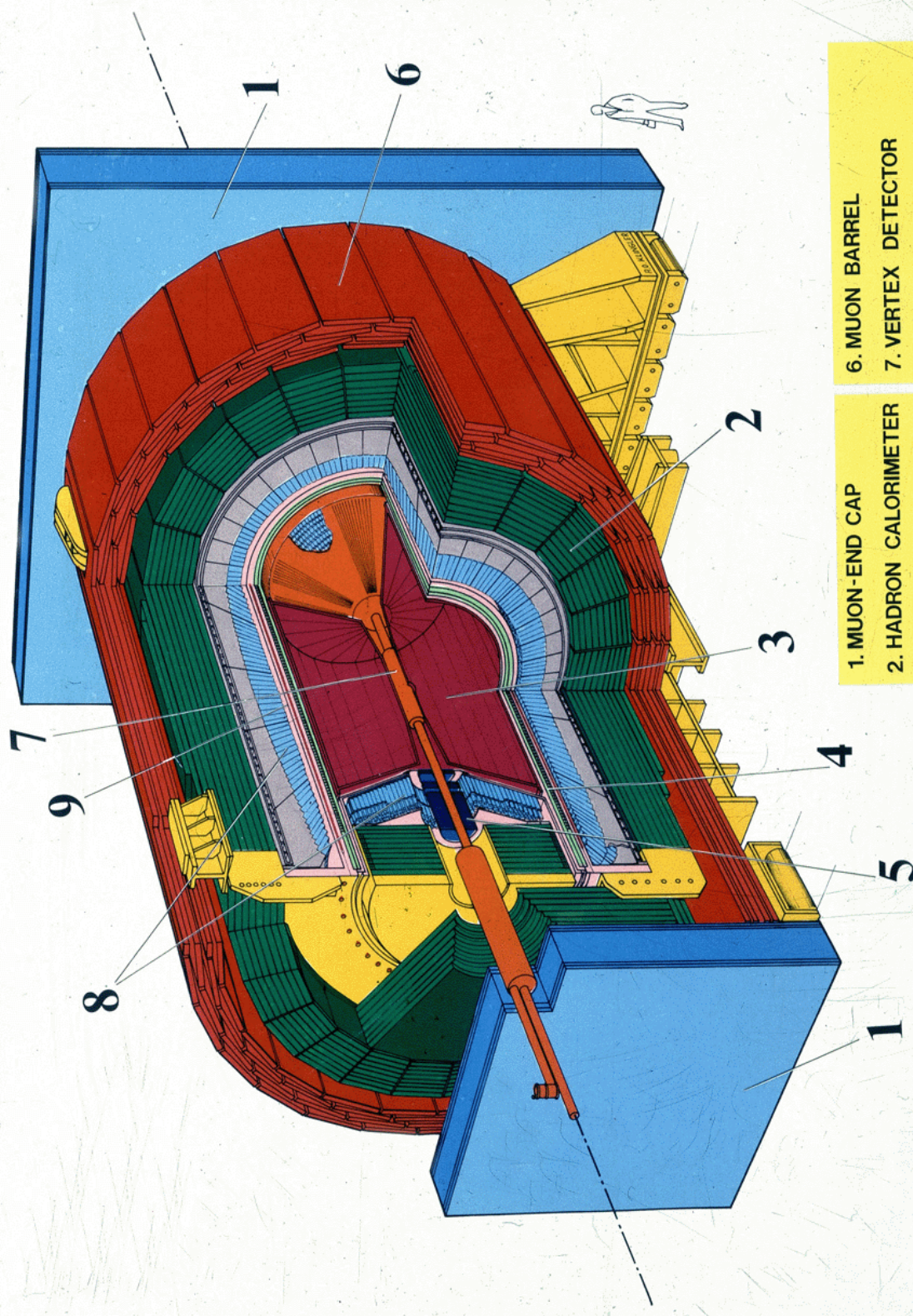

- 1. MUON-END CAP
- 2. HADRON CALORIMETER
- 3. JET CHAMBER
- 4. MAGNET COIL
- 5. FORWARD DETECTOR
- 6. MUON BARREL
- 7. VERTEX DETECTOR
- 8. LEAD GLASS
- 9. PRESAMPLER AND TIME-OF-FLIGHT DETECTOR

L3

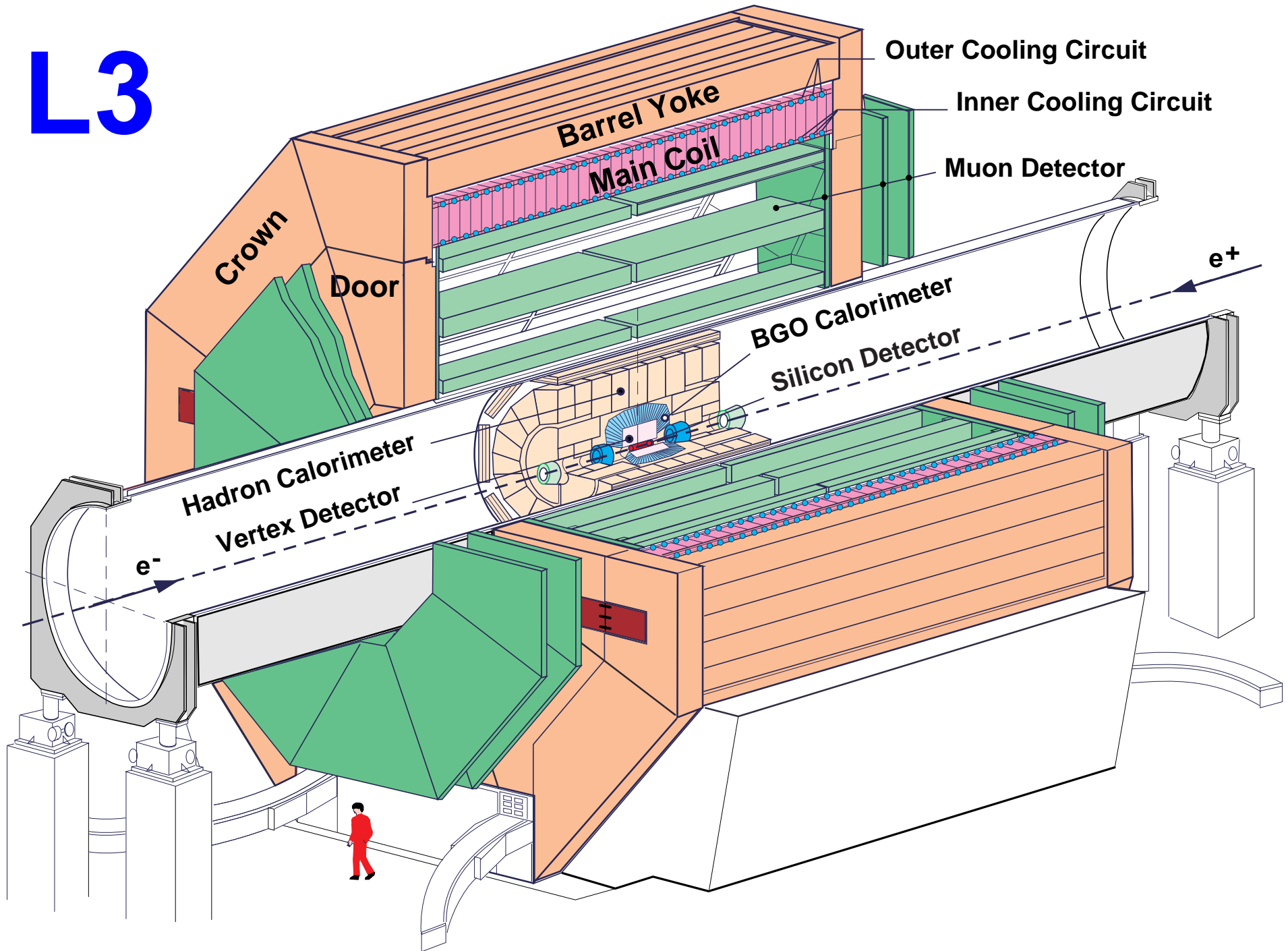

CDF Detector Evolution

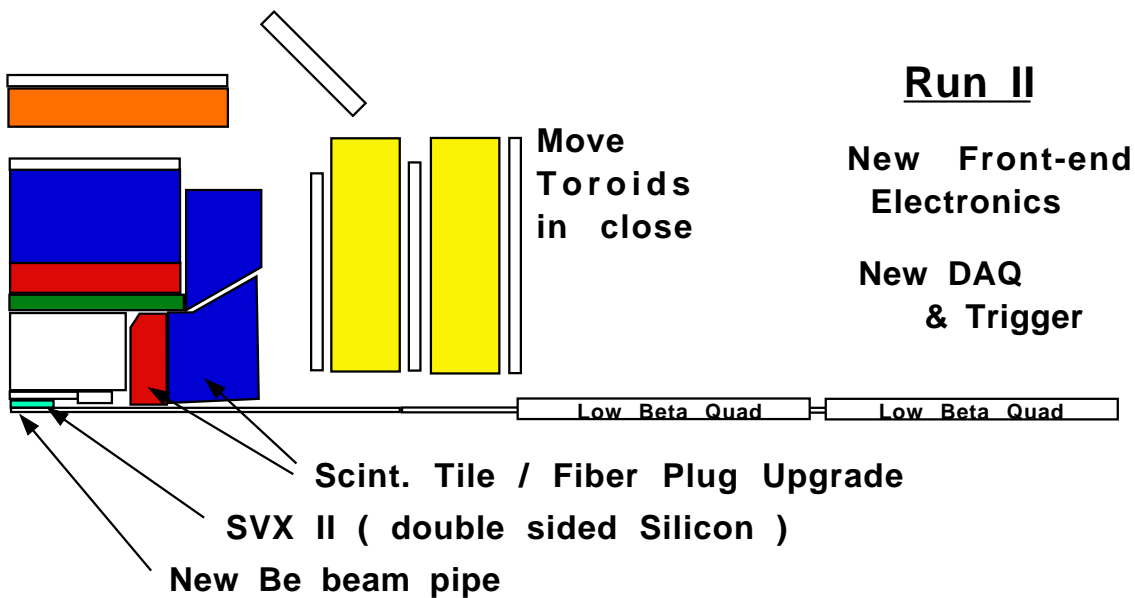
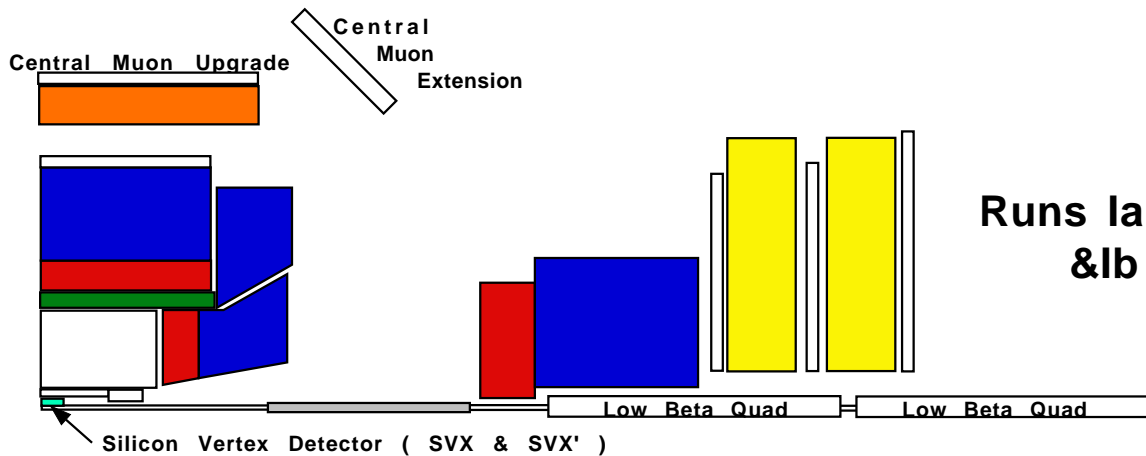
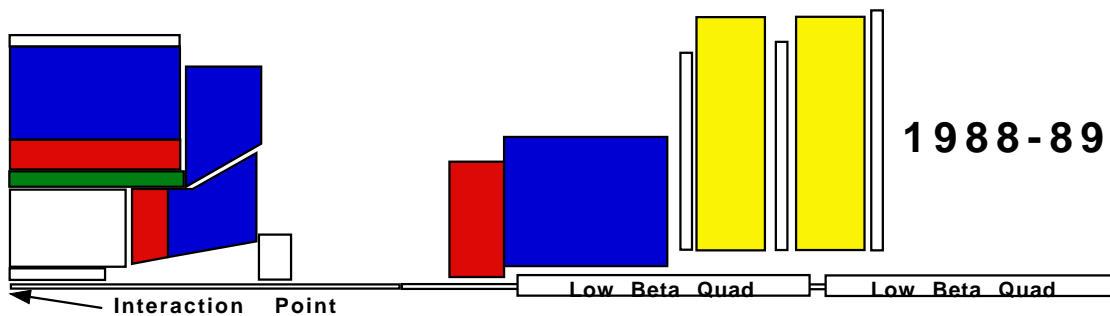

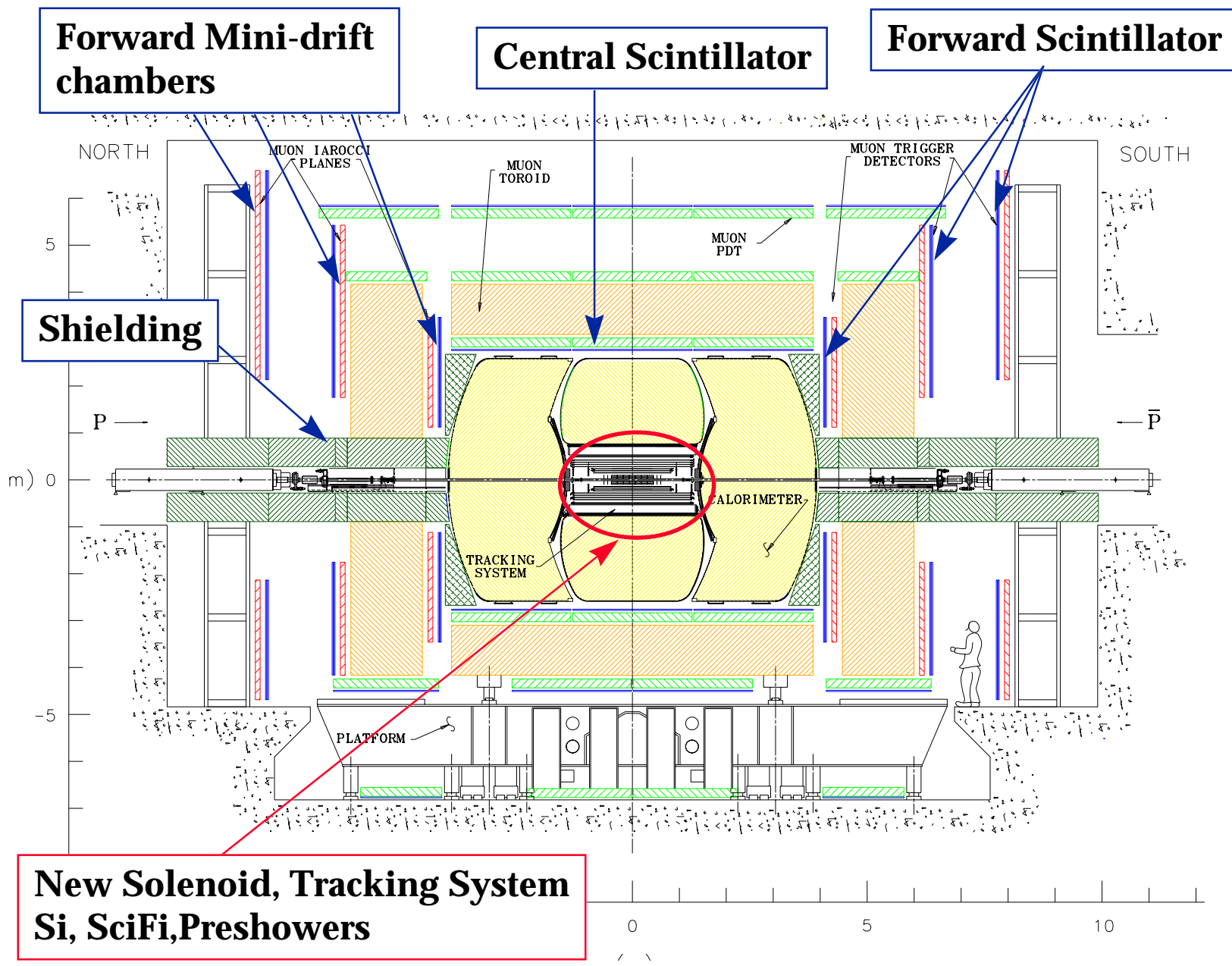

**New Solenoid, Tracking System
Si, SciFi, Preshowers**

+ New Electronics, Trig, DAQ

D0 Upgrade

THE H1 DETECTOR

Forward Muon System

Central Muon System

Forward Tracker

Central Tracker

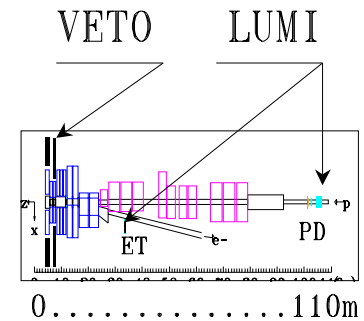
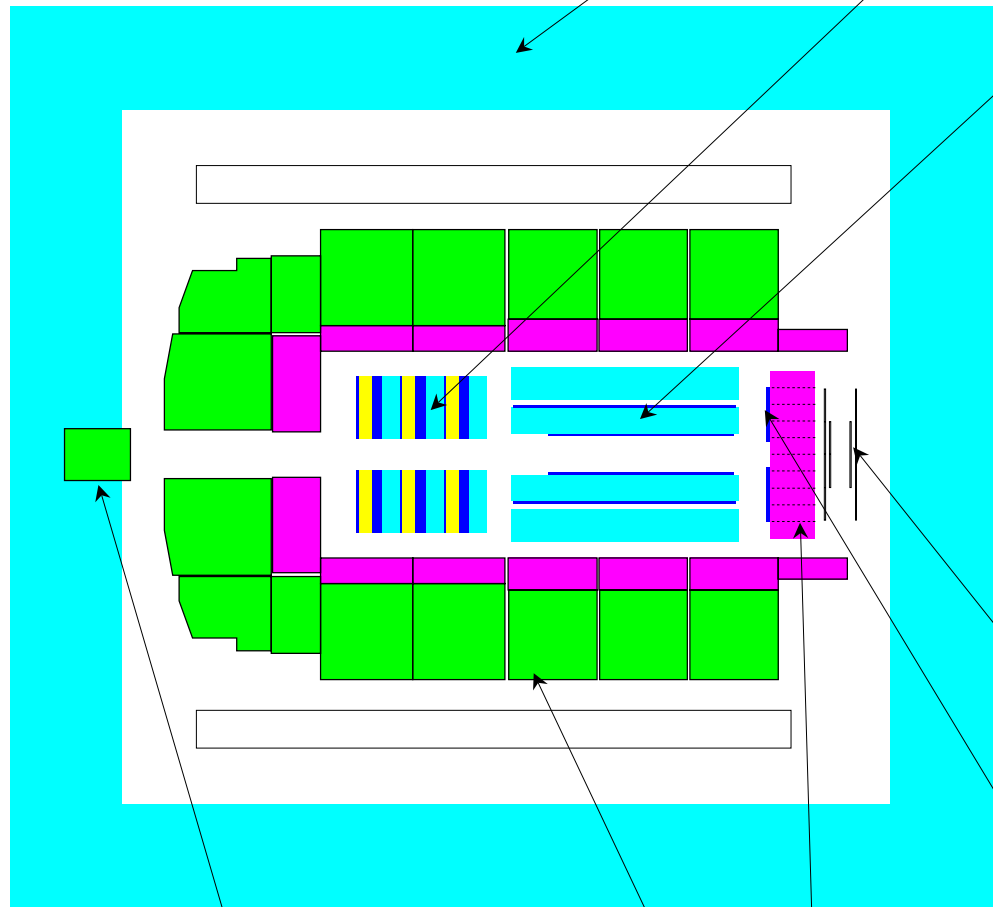
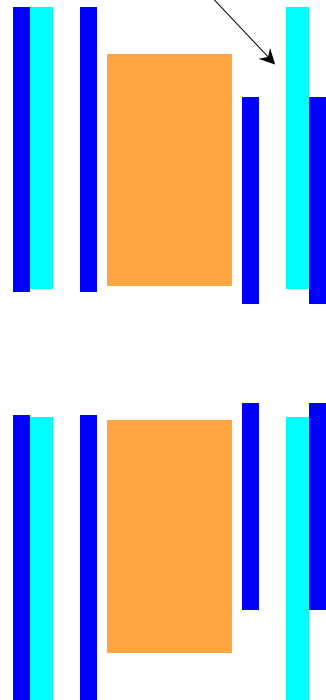

Scintillators

Backward MWPC

PLUG Calorimeter

LAr Calorimeter

Backward Calorimeter



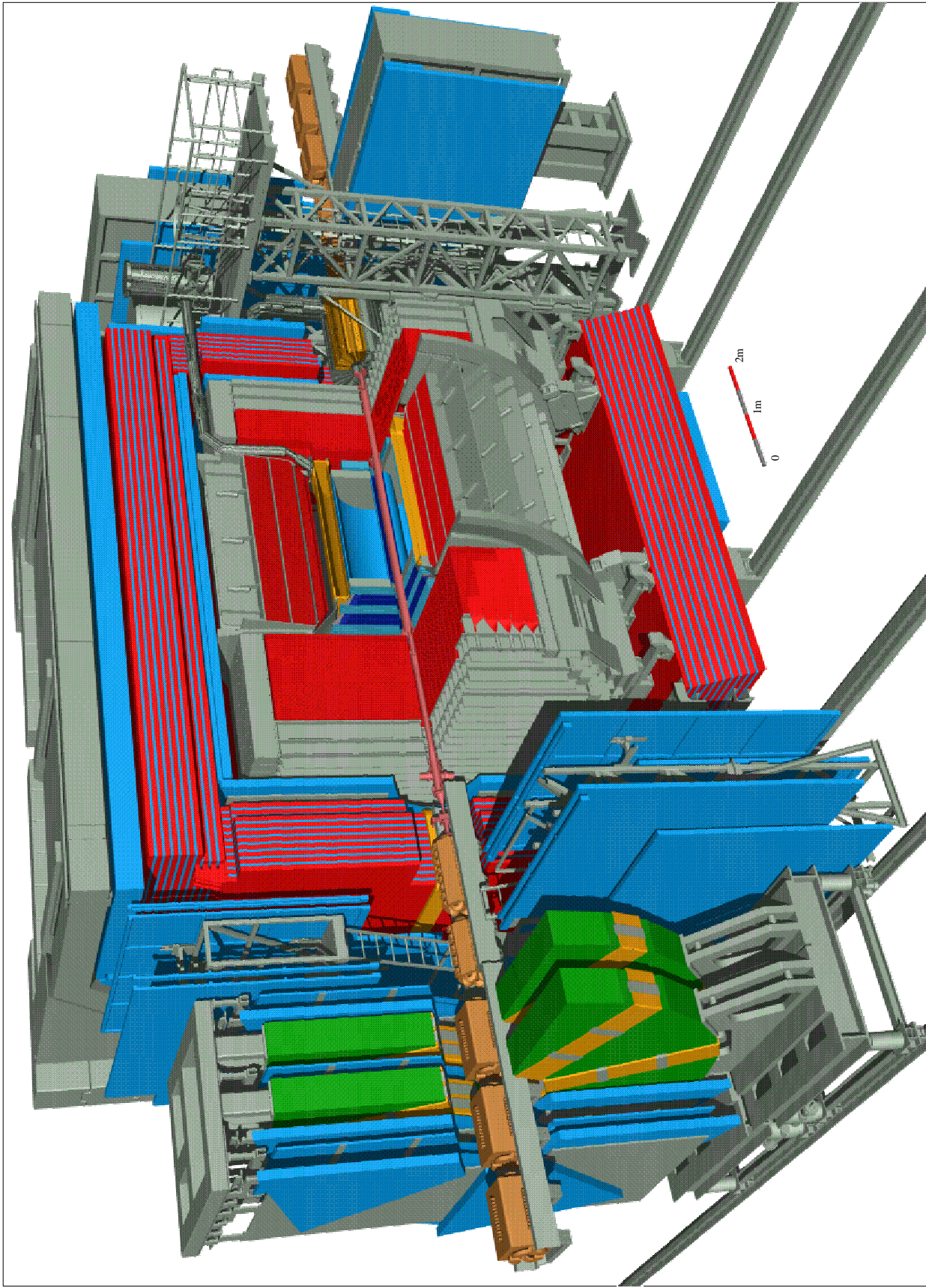

Software :SDRC-IDEAS level VLi
Performed by : Carsten Hartmann
Status : October 1993

